



**Intellimix<sup>®</sup>**  
Hygiene. Redefined.



Ideal Standard

---

TOGETHER FOR BETTER

**Over 100 years  
of hygiene heritage.  
And counting.**

The daily practice of hygiene is exactly that, something which should improve day after day. At Ideal Standard, we're incredibly proud to have played a leading role in that daily improvement for more than a century.

Today, we're more aware than ever of the need to keep raising standards and creating new solutions that deliver superior hygiene. Through our research and industry-leading products, we make it possible to deliver safer, better, washroom experiences.

Shaping the future of modern living, together.



Ideal Standard



Intellimix® — Deck mounted, Chrome / Conca — Basin 100cm / Conca — Mirror 80cm

INTRODUCING INTELLIMIX®

## Hygiene. Redefined.

Rising to the challenges of the modern world calls for a new definition of hygiene. That's why we created Intellimix® – a smart touchless tap that dispenses both water and soap. It encourages users to always wash with soap, which the World Health Organisation recommends as one of the most important measures we can take to avoid contracting and spreading infections.

Intellimix® doesn't just deliver superior hygiene, though – it also reduces running costs, improves sustainability, and even makes maintenance simple thanks to the Intellimix® app.

### SUPERIOR HYGIENE

Limit the spread of harmful bacteria with touch-free handwashing that encourages soap use every time.

P.08

### LASTING SAVINGS

Reduce your running costs with lower maintenance needs and by saving on water and soap with every use.

P.14

### NEXT-GEN SUSTAINABILITY

Reduced water and soap consumption over the lifetime of the product.

P.18

### DESIGNED FOR BETTER

Sophisticated design, finish options and customisable digital display.

P.20



Intellimix® – Deck mounted, Chrome / Extra – Double basin 120cm  
Conca – Mirror 120cm

SUPERIOR HYGIENE

# When soap meets water

We all know that proper handwashing technique protects people from infection and reduces illness and absenteeism. What's less known is that proper handwashing doesn't come naturally to people.

The World Health Organisation recommends using soap and scrubbing for at least 20 seconds to protect our health. Intellimix® makes correct handwashing a certainty, by delivering a programmable amount of soap and water in a complete, timed wash cycle.

**30%**

people don't use soap when washing their hands, after visiting the toilet.

**80%**

of the most common diseases are transmitted by touch.

**95%**

people don't use soap or not enough water, enabling germs to spread more easily.



DIGITAL HANDWASHING CYCLE

# 100% soap washes



SUPERIOR HYGIENE

# Where innovation meets intuition

Our technologists work tirelessly to push the boundaries of what's possible when it comes to design, engineering, and invention.

Add to this our deep knowledge of users' needs and behaviour, and you have a solution that not only works, but works for everybody.



**TOTALLY TOUCHLESS**

Intellimix® automatically delivers water and soap when a user puts their hands under the tap. The screen then explains what is happening, and how to follow the wash cycle.



**100% SOAP WASHES**

Intellimix® Mild Antibacterial Foam Soap is automatically dispensed as part of the washing cycle. This ensures better hand hygiene with every wash.



**STAGNATION PROTECTION**

A periodic hygiene flush is triggered automatically after a set time, rinsing the pipes to safeguard against bacteria growth.



**IDEALBLUE®**

A separate water tube ensures there is no contact between the water and the brass body of the tap – keeping the water nickel and lead free, in line with drinking water regulations. The small diameter lets the water flow faster – preventing the build-up of bacteria.





SUPERIOR HYGIENE

## A soap with a difference

### A UNIQUE FORMULA

Intellimix® Mild Antibacterial Foam Soap is our own formula created to ensure perfect hygiene while being gentle to even the most delicate skin.

Irritant-free and with a rich, thick texture, it offers a luxurious handwashing experience every time.

### TRIED & TESTED



Vegan and cruelty free.

No fragrance, colourants, EO/PEG, sulphates, or microplastics.

100% naturally derived surfactants for a gentle hand-wash.

### KIND TO YOUR SKIN, GOOD FOR THE PLANET

Intellimix® Mild Antibacterial Foam Soap comes in a recyclable 1250ml bottle which is easy to replace in two simple steps, without the use of tools.



LASTING SAVINGS

## Cost control, made effortless

Proper hand hygiene is priceless for individuals, and for business. With Intellimix® you can have all the personal benefits, and save on your running costs, too.

 **SAVE UP TO 80% ON SOAP**

Intellimix® mixes soap with air to create a soft foam that is not only pleasant on the skin, but is also economical. The soap volume can be adjusted via the App to give total control to the owner and so they can monitor how much is used. The soap is dispensed from a long life pump that has a tested lifespan of over 500.000 cycles.

 **SAVE UP TO 85% ON WATER**

Intellimix® uses 85% less water when compared with standard single lever taps, when following the washing cycle recommended by the WHO.

The 2 l/min flow limiter and programmable water flow timing bring significant cost savings as the table below shows.

### Intellimix® compared to standard taps with 5.8 l/min flow rate

Timings based on World Health Organisation handwashing cycle

Product	Flowrate	Wet your hands for 5 seconds	Lather and scrub for 20 seconds	Rinse for 10 seconds	Water usage sec/l	Water saving
Manual mixer	5.8 litres/min	5 sec flow	20 sec flow	10 sec flow	35 sec 3.38 l	0%
Infrared mixer	5.8 litres/min	5 sec flow	0 sec flow	10 sec flow	15 sec 1.45 l	57%
Intellimix®	2 litres/min	5 sec flow	0 sec flow	10 sec flow	15 sec 0.5 l	85%



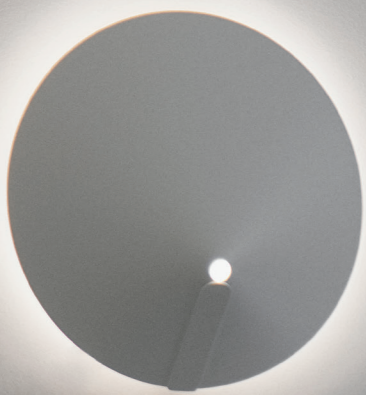

**SAVE ON  
PHYSICAL  
MAINTENANCE**

Intellimix® saves hours of work, especially in larger buildings with multiple washrooms. EasyFix® enables effortless installation, saving time and money on the initial set up. Plus, with no more dripping soap dispensers, Intellimix® means reduced cleaning time and costs.



Intellimix® – Deck mounted, Black Onyx / Connect – Undercounter top basin 50cm

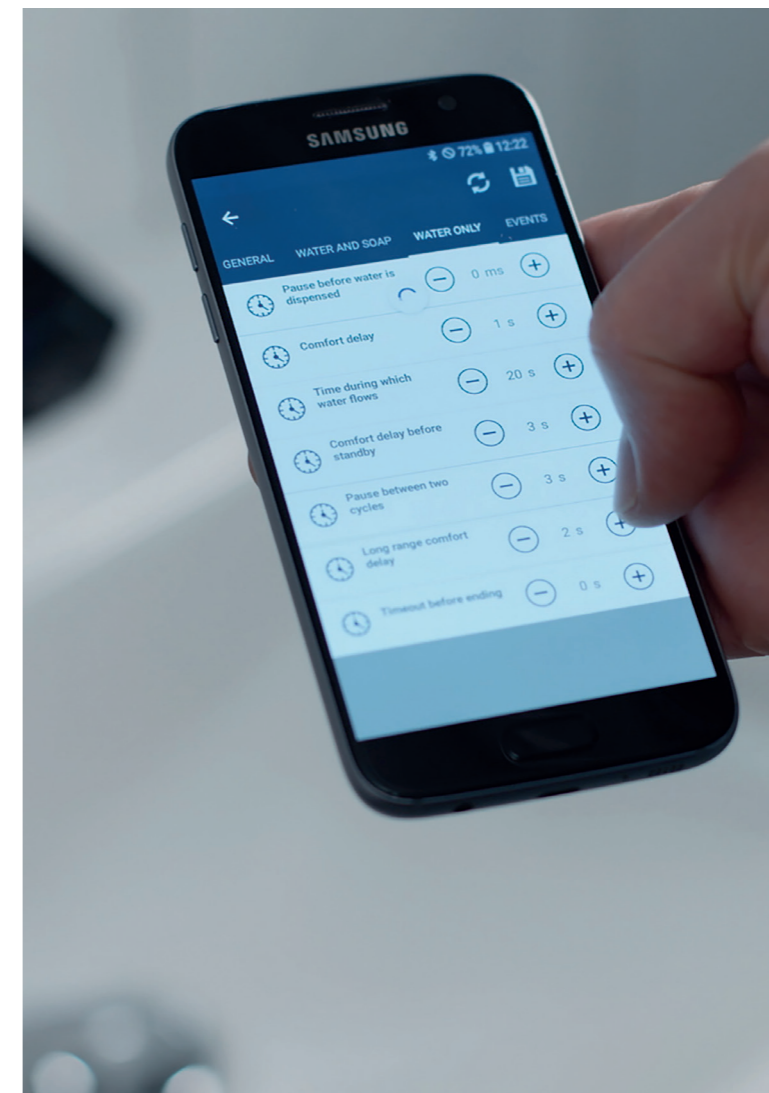

**MANAGE  
RESOURCES  
EFFORTLESSLY**

Intellimix® makes controlling resources simple with its bespoke app for Android and iOS. You can adjust parameters such as soap settings and the handwash cycle to meet changing needs, and control the frequency of the automatic hygiene flush.

You can also monitor performance and receive alerts when supplies are low – all helping to make significant savings on water and soap.

NEXT-GEN SUSTAINABILITY

# Higher standards

Sustainability is more than a box to be ticked. It's a promise to keep. Intellimix® helps you keep that promise, by prioritising sustainable resource management.

With smarter soap use, fewer chemicals make their way into the water supply and the costs and impact of cleaning is reduced. Significant water savings, along with the option to switch to cold water hand washing, mean sustainability isn't just a buzzword. It's a reality.

BREEAM

BREEAM is the world's leading sustainability assessment method for masterplanning projects, infrastructure and buildings. It recognises and reflects the value in higher performing assets across the built environment lifecycle, from new construction to in-use and refurbishment.

Installing Intellimix® would award you 5 credits.

BREEAM performance levels for water consumption of collective buildings

Application	Water usage l/min
Baseline	12 litres/min
1 Credit	9 litres/min
2 Credits	7.5 litres/min
3 Credits	4.5 litres/min
4 Credits	3.75 litres/min
<b>5 Credits</b>	<b>&lt;3 litres/min</b>



Intellimix® — Deck mounted, Chrome / Contour 21 — Wash trough 120cm / Conca — Mirror 120cm

DESIGNED FOR BETTER

# Clean hands, clean design

Every product we create is designed with the user in mind. Intellimix® is a modern, elegant, and effortless solution that elevates its surroundings and results in a better-than-ever washroom experience.

Intellimix® has won awards in recognition of its design and advanced technology.



Intellimix® — Deck mounted, Chrome / Conca — Basin 100cm



reddot winner 2021



### DIGITAL SCREEN

Intellimix® uses its screen to share clear instructions, so users understand how to use the tap and get the best experience. It can also be programmed to show your logo.

DESIGNED FOR BETTER

## Intellimix® Black Onyx







Intellimix® doesn't just transform your washroom through innovation. In a sleek Black Onyx colour way, it also creates a bold, impactful look so you can deliver the latest in design, as well as the latest in technology.

For a more classic style, you can also choose a chrome finish.

Both are available as deck mounted fittings, with panel mounted models coming soon.



Key

-  Totally touchless
-  Integrated soap dispenser
-  Water saving
-  Sustainable
-  EasyFix® installation
-  App compatibility
-  Automatic hygiene flush

**Intellimix®  
Smart Soap Integrated Sensor Tap**  
Chrome finish  
A7488AA



**Intellimix®  
Smart Soap Integrated Sensor Tap**  
Black Onyx finish  
A7488B3



Touch-free and soap integrated hand washing  
Without hot and cold water mixing  
Suitable for connection with individual thermostat A3813NU or micro thermostat A5776AA (to be purchased separately)  
Integrated soap outlet for Intellimix® Mild Antibacterial Foam Soap  
Product is only for use in high pressure systems (min. 0,5 bar)  
Integrated solenoid valve  
Saves water thanks to a flow limiter 2 l/min  
TFT animated display for intuitive mixer use (with additional personalisation option)  
Intellimix® meets all standards for materials in contact with drinking water  
EasyFix® for quick and effortless installation  
Standard fixation with flexible hoses G3/8" PEX to reduce the bacteria's' growth  
With plug in power adapter 100-230 V AC, 50-60 Hz, 6 V DC  
Programmable automatic hygiene flush  
Programmable automatic rinse for soap  
Easy parameter setting through app  
Easy data check through app

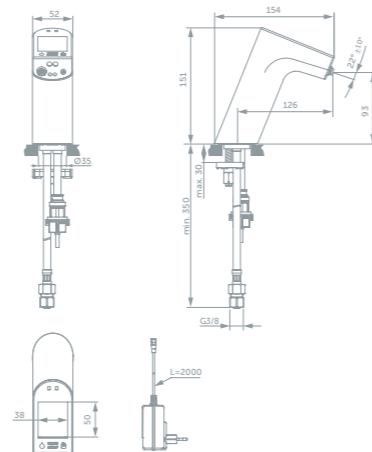

**Intellimix® Mild  
Antibacterial Foam Soap**

- 1.25L x 6 Packs      1.25L x 240 Packs  
A7711NU              A7714NU
- 1.25L x 120 Packs  
A7713NU

Bespoke Intellimix® formula  
1250ml recyclable bottles  
Mild formula for gentle cleansing  
100% naturally derived surfactants  
Free from fragrances, colourants and alcohol  
Free from EO/PEG and sulphates  
Vegan and cruelty free  
Free of microplastic



For more information  
about basins and furniture  
visit our website.

**Pre-mixer thermostatic control  
with thermal disinfection**  
A5776AA



**Pre-mixer installation set**  
A5777AA



**Power supply  
elongation 2m**  
A960635NU



**Conca**  
Basin Unit  
600 x 505 x 370 mm  
T3928

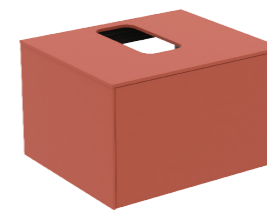

Available in more sizes and  
six different finishes  
Compatible with  
Conca and Extra basins.

**Conca**  
Basin  
500 x 450 mm  
T3812



Basin with overflow  
1 tap hole, grinded  
Available in white gloss and white silk

**Extra**  
Basin  
500 x 450 mm  
T388401



Basin with overflow  
1 tap hole, grinded  
White gloss

**Connect Air**  
Basin unit  
480 x 409 x 400 mm  
E0844

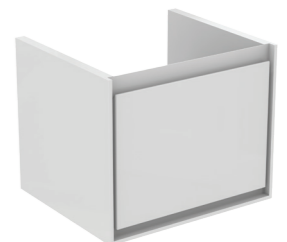

Available in four different finishes  
Compatible with  
Connect Air basin  
E029901

**Connect Air**  
Basin  
550 x 460 mm  
E074401



Basin with overflow  
1 tap hole

**Adapto**  
Basin unit  
700 x 380 x 505 mm  
U8595



Available in four different finishes  
Compatible with  
Strada II basin  
T300001

**Adapto**  
Basin unit  
600 x 380 x 505 mm  
U8594



Available in four different finishes  
Compatible with  
Strada II basin  
T300001

**Strada II**  
Basin  
600 x 430 mm  
T300001



Basin with overflow  
1 tap hole  
Ceramic waste cover included

Together we positively impact the future of modern living. Together we think bigger. Together we establish the rules for considered design. Together we bring emotion to functional perfection. Together we form enduring partnerships. Together we meet the needs of all generations. Together we shape the future of the category we have defined.

Together for Better.



Ideal Standard

**Ideal Standard-Vidima AD**

53 Marin Popov Street  
5400 Sevlievo, Bulgaria  
Tel: +359 675 30362  
office@idealstandard.com

**Representative office, Riga**

A. Briana str. 9a,  
Riga, LV- 1001, Latvia  
Tel: +371 673 57 792  
Fax: +371 673 57 795  
VDorogoi@IdealStandard.com

**Representative Office, Bucharest**

Calea Victoriei Nr. 109,  
010069 Bucharest, Romania  
Tel: +40 21 322 3201  
Tel: +40 21 322 3202  
OfficeBucharest@idealstandard.com

**Representative office, Belgrade**

Drinčićeva no.19, apartment no.8  
11000 Belgrade, Serbia  
Tel/Fax: +381 11 7138 058  
Tel/Fax: +381 11 7138 059  
OBelgrade@IdealStandard.com

**Representative Office, Budapest**

IS-Hun Kft  
1094 Budapest, Hungary  
Viola u 16-18  
Tel: +36 30 6991 594  
ZGarai@idealstandard.com

**Contact for Albania, Kosovo  
and Bosnia & Herzegovina**

Tel: +359 887 709 696  
IMichev@idealstandard.com

**Contact for Croatia**

Tel: +38591 22 99 304  
HPavicic@idealstandard.com

**Contact for Slovenia**

Tel: +39 040 2158058  
info@liaison.it



Ideal Standard